

Be-Ge 8116/8416



8116 can be equipped with headrest



8116, larger version



8416, smaller version

Be-Ge 8116/8416 series are suspended driver seats with a low profile and tiltable seat cushions. The suspension unit is placed behind the seat and is weight adjustable.

The seat and back cushions are available in two different sizes, the 8116 is the larger version and the 8416 is the smaller version.

The 16-series is suitable for forklifts and vehicles that demand high seating comfort, low profile and a robust construction. Service is easy made – the cushions can be switched with an easy operation.

BE-GE

— Establ. 1934 —

Be-Ge 8116/8416

The seats are mechanically suspended with the suspension unit behind the seat and stepless weight adjustment of 60–130 kg.

The seat cushion can be tilted 7° in 3 steps and the back cushion can be adjusted 9°–24° in the 8116 and 5°–20° in the 8416, both in four steps. The length can be adjusted 160 mm.

The seats fulfil the vibration norms according to EN1390 IT1 and IT2. With 2-point belt they also fulfil the FEM section IV for industrial fork lifters.

OPTIONS:

The seats can be equipped with electrical heating in 12V, 24V or 48V, 2-point waist belt with roll (electrical switch as extra option) or fixed belt.

81-16 can also be equipped with armrests and headrest (headrest demands preparation of back cushion from the factory).

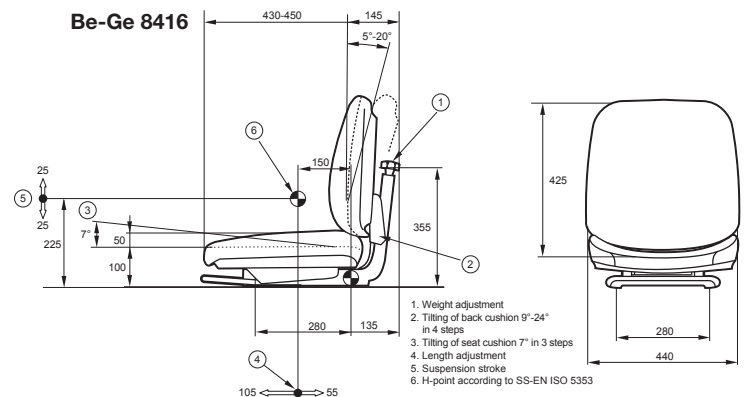
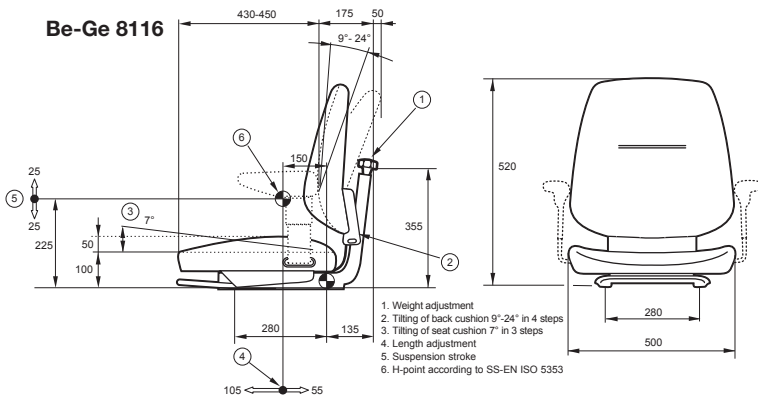
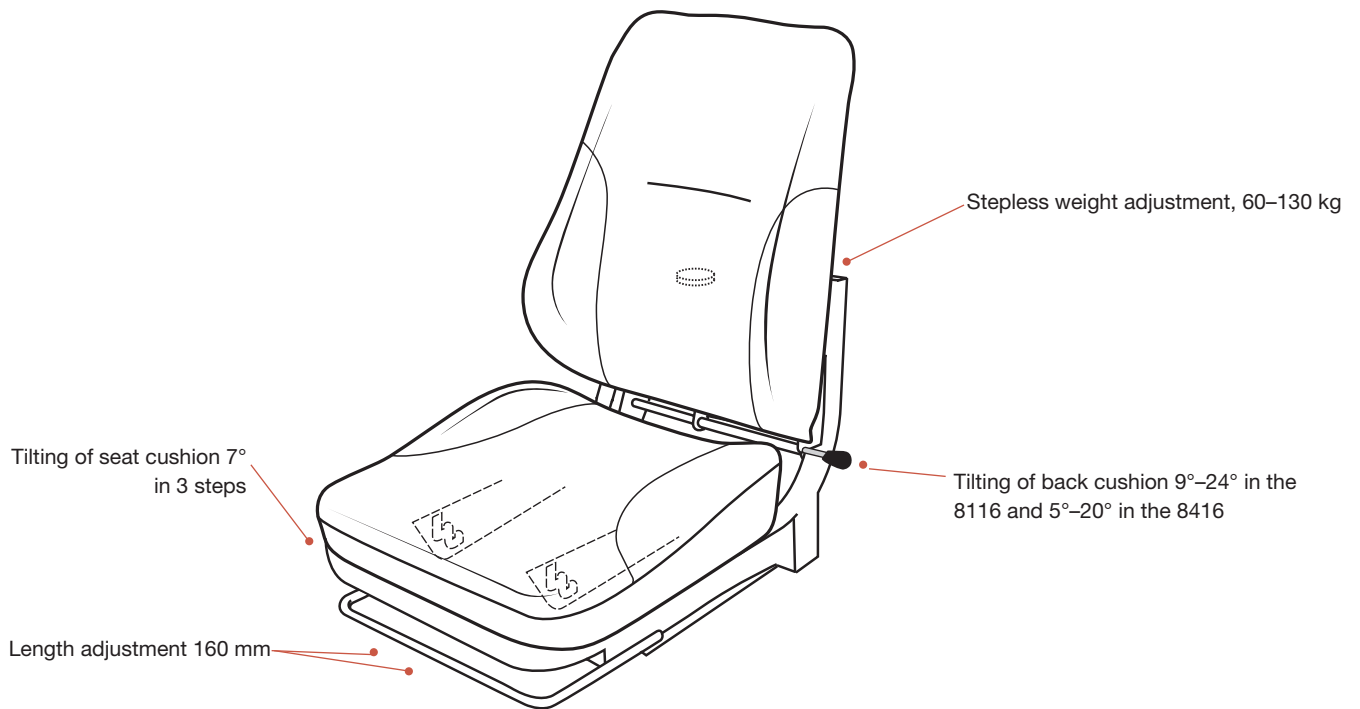

Be-Ge Industri AB

Box 912 SE-572 29 Oskarshamn, Sweden. Telephone +46 (0)491-761800.
info@be-ge.se www.be-ge.com Telefax +46 (0)491-81900.

Be-Ge Seating UK Ltd

Venture Center, Sir William Lyons Road UK-Coventry CV4 7EZ
Phone: +44 844800 0558 Fax: +44 844800 0559 www.bege.co.uk